

# AIRFIX DRAW ALIGNER



Dent removal

Ref. 077379

The AIRFIX DRAW ALIGNER is an indispensable asset for auto-body specialists performing dent removal work. The patented design features a non-glued, recessed seal that can be changed in a matter of moments. In addition, 4 pads in the vacuum prevent the gasket from slipping, which makes it even more robust. It is easily one of the most reliable dent pulling systems on the market.

## INNOVATIVE AND PATENTED DESIGN

- The suction cup plate is equipped with 4 rubber pads, which absorb the shearing forces when pulling.
- The surrounding seal is recessed without glue.
- The seal and the pads are easily replaceable.

## POWERFUL AND EFFECTIVE PULLING

- Pulling capacity up to 770 lb across the whole height of the unit.
- Max. pulling height of 52".
- Crank winch with Ø6 mm wire rope (3300 lb tensile strength).
- Slide system to adjust the pulling height in seconds and without the need for any tools.
- Angled gear to facilitate downward pulling.

## ERGONOMIC DESIGN

- Lightweight (68 lb) and easy to move with two wheels.
- Low noise level achieved by a high performance silencer.

## OPERATION

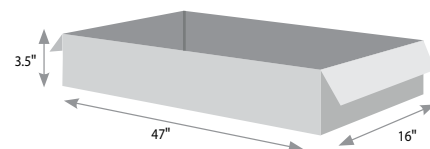
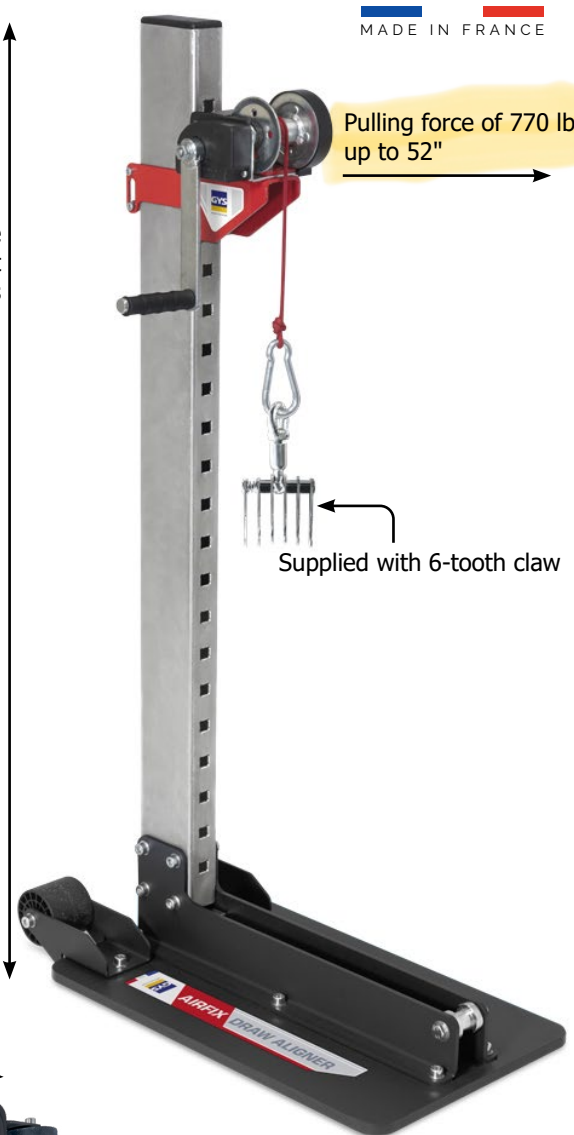
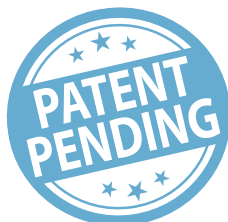
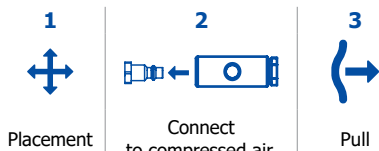

## SPARE PARTS

Wire rope	079588	78"
Seal for plate	079571	68"

kg	max.	
68 lb	72 > 116 PSI	R 1/4
		R 1/4

MADE in FRANCE

[www.gys.fr](http://www.gys.fr)